



**R-EVO CHAMPIONSHIP
TECHNICAL AND SPORTS REGULATIONS
2026**

GENERAL CONTENTS

SPORTS REGULATIONS

RS1	PROMOTER	p.3
RS2	NATIONAL SERIES	p.3
RS3	RANKINGS and SCORES	p.4
RS4	ADMITTED DRIVERS AND LICENCES	p.5
RS5	REGISTRATIONS	p.5
RS6	KARTS ADMITTED	p.5
RS7	TYRES	p.6
RS8	RACE FORMAT	p.6
RS9	WET RACE	p.7
RS10	COMPLAINTS and APPEALS	p.7
RS11	PRIZES	p.8
RS12	GENERAL RULES	p.8

TECHNICAL REGULATIONS

RT1	R-EVO CHAMPIONSHIP TECHNICAL RULES	p.9
RT2	FRAME and accessories	p.9
RT3	ENGINE and accessories	p.11
RT4	TYRES	p.15
RT5	MASS	p.15
RT6	FUEL	p.15
RT7	TRANSPONDER	p.15
RT8	RACE CLOTHING	p.16
RT9	TELEMETRY	p.16
RT10	ADVERTISING	p.16
RT11	GENERAL RULES	p.16

NATIONAL SERIES CALENDAR

	NATIONAL SERIES CALENDAR	p.17
--	--------------------------	------

RS1) SPONSOR

RS1.1) TBKART srl organises and promotes the R-EVO CHAMPIONSHIP promotional karting series, under the auspices of ACI Sport (National ASN), entrusting the organisation to the KartSport Circuit ASD sports club. The aim of the project is to encourage and promote competitive karting, and for this reason the race format and regulations include a series of measures designed to keep costs down. The Series will be reserved for drivers holding an ACI driver's licence and will be run exclusively with TBKART karts, Rotax Max Junior EVO engines and SHINKO tyres, as described in the Technical Regulations. The organisation of individual Championship races will be managed by KartSport Circuit ASD and/or delegated to sports societies, clubs and/or organisers holding an ACI Sport Organiser Licence and authorisations in accordance with current ACI Sport regulations.

RS1.2) These Regulations, the appendices approved by the ASN, information bulletins, race calendars, rankings and all official information will be made available on the Series website (www.irkpromotion.com) and will take full effect from the date of publication.

RS2) NATIONAL SERIES

RS2.1) The Italian National R-EVO CHAMPIONSHIP Series is reserved for the following 2 categories:

CATEGORY	AGE	CHASSIS	ENGINE	WEIGHT
Senior Light	13 years*	TBKART S197	Rotax Max Junior Evo	155 Kg
Senior Heavy	15 years*	TBKART S197	Rotax Max Junior Evo	160 Kg

RS2.2) The National Championship will be awarded for each category in 6 trials (race days) and in each of these events there will be 2 Finals (Race 1 and Race 2) for a total of 12 races valid for the awarding of points, as described in the following point RS3. For each driver, the best 10 results obtained will be considered valid, and it will be mandatory to count the points from the last championship race (which cannot be discarded). The 2026 calendar is published on the Championship's official website and is included as Annex "A" at the end of this document.

RS2.3) Participation in the races listed in the calendar is permitted subject to mandatory and free registration on the official championship website (www.irkpromotion.com). The races will take place on a single day, preferably on a Saturday or Sunday.

RS2.4) Alongside the National Series, additional individual/spot events may be authorised, including those involving multiple trials. Karts that comply with the R-EVO Championship Sporting and Technical Regulations and drivers who have registered in advance on the official website and hold a Karting Licence are eligible to participate in these events. Competitors and Drivers holding a National/International ACI Karting Competitor/Driver and Driver license are eligible to participate in the races.

Competitors and Drivers holding a national license issued by a foreign ASN (National Sporting Authority) are eligible to participate and must be in possession of an authorization issued by their National Sporting Federation as provided for in Article 14 of the RSN 2026. (see Article 4 RDSSK 2026)

The RSN 2026 is published on the ACI Karting website and in the official ACI Karting calendar.

The RSN 2026 is published on the ACI Karting website and in the official ACI Karting calendar.

as required by Article 14 of RSN 2026. (see Article 4 RDSSK 2026)

In the case of Championships involving multiple events, points will be awarded according to the criteria set out in point RS3.1 below.

*see point RS4.1

SPORTS REGULATIONS**RS3) RANKINGS & SCORES**

RS3.1) Each Final will result in the awarding of points for each category participating in the race, as shown in the table below. The format of the national events will include the awarding of points for both scheduled finals (Race 1 and Race 2).

RS3.2) The starting grid for Race 1 is determined by the qualifying results. The first eight places on the starting grid for Race 2 are determined by reversing the finishing order of Race 1: the winner starts eighth, the competitor who came in 2nd starts seventh, and so on, until the eighth-place finisher starts in pole position.

RACE 1		RACE 2	
<u>POSITION</u>	<u>POINTS</u>	<u>POSITION</u>	<u>POINTS</u>
1st place	25	1st place	25
2nd place	20	2nd place	20
3rd place	18	3rd place	18
4th place	15	4th place	15
5th place	12	5th place	12
6th place	10	6th place	10
7th place	9	7th place	9
8th place	8	8th place	8
9th place	7	9th place	7
10th place	6	10th place	6
11th place	5	11th place	5
12th place	4	12th place	4
13th place	3	13th place	3
14th place	2	14th place	2
15th place	1	15th place	1

RS3.2) For the purposes of the Final Classification of the National Series, the best 10 results will be considered valid. It will not be possible to discard:

the result of non-participation in a National Series race

Any disqualifications for technical non-compliance or serious breaches of the Sporting Regulations (exclusion from the rankings) will also be identified with 0 points in the rankings.

The penalty of relegation to last place for minor offences will result in the assignment of 0 points in the ranking, but with the possibility of discarding the result.

RS3.3) Points are awarded exclusively in all races with a minimum of 10 drivers registered.

RS4) ADMITTED DRIVERS AND LICENCES

RS4.1) All drivers who are 13 years of age or older, or who will turn 13 during the year, will be admitted to the SENIOR LIGHT category.

All drivers who are 15 years of age or older, or who will turn 15 during the year, will be admitted to the SENIOR category.

RS4.2) Any exceptions for early entry into a higher category or extended participation in the current category beyond the permitted age limit may only be granted by the Promoter, subject to authorisation by ACI Sport, where there are objective reasons for doing so.

RS4.3) All drivers, regardless of their category, must hold a competitor/driver licence issued by ACI Sport.

RS5) REGISTRATION

RS5.1) Registration for individual races will take place according to the times and procedures indicated by the individual organisers.

RS5.2) The documents required to participate in races are an ACI Sport driver's licence, a valid medical certificate as required by your licence (original competitive certificate or sports medicine certificate depending on the licence you hold) and a completed form certifying the conformity of the technical clothing used in the race (self-certification).

RS5.3) The driver will receive passes from the organiser to access the track and technical areas, when required by the circuit owners.

RS5.4) The registration fee for individual races for the 2026 season is set at Euro 150.00.

RS6) KARTS ADMITTED

RS6.1) A chassis manufactured by TBKART. A ROTAX engine, based on a turnkey principle to be applied throughout the series. The engines will be drawn during the distribution of materials by TBKART Ltd. every day after the last session. The competitor is responsible for returning the engine to the organiser in good condition and clean; failure to comply with the official instructions of the manufacturers will result in a penalty imposed by the race stewards. Every morning, the manufacturer will draw lots again to assign the engine to all drivers, in the presence of at least one steward. The outcome of this procedure cannot be subject to protest or appeal. Only karts that comply with the CIK-FIA Karting Technical Regulations may be admitted to a competition.

RS6.2) Each driver will receive a kart at the first event of the series and must use that chassis for the entire series. In the case of participation in a single event, drivers will receive a chassis solely and exclusively for participation in that single event.

RS6.4) The kart, complete with all components supplied by TBKART, cannot be modified in any way and must be used as supplied. The gear ratio (rear crown wheel-engine pinion) must be that specified by the kart supplier.

RS6.5) TBKART srl reminds participants that they are liable for any damage caused to the kart entrusted to them, regardless of their responsibility, particularly in the following cases: leaving the track, driving on abrasive surfaces, hitting cones, contact, collision, etc. Drivers are required to compensate TBKART srl for any damage caused before leaving the competition venue.

RS6.6) At the discretion of the Stewards, the Inspectors shall be authorised at any time during the Competition to replace the Competitors' equipment, for example: chassis, engine, carburettor, ignition, intake silencer, axle, accessories, etc., with the equipment of another Competitor or with equivalent replacement equipment taken from the warehouse by drawing lots.

RS7) TYRES

RS7.1) Tyres shall be of a single type manufactured by SHINKO, as specified in the Technical Regulations. For each individual race, the use of the following will be permitted:

Unofficial free practice: participants may use the set of tyres used in the tests/previous race.

Official free practice: participants may use the set of tyres used in the tests/previous round.

Qualifying tests: participants shall use the set of new tyres provided by the organiser; the same set shall be used for RACE 1 and RACE 2.

Each participant will be assigned a set of RAIN tyres at the start of the season at a price of €190.00 including VAT.

The set of RAIN tyres purchased will remain available to the participant for any WET RACES during the National Series. There is no requirement for new tyres in WET RACE; tyres used during the National Series may be used.

The Promoter reserves the right to require the use of new tyres at any international meetings.

RS8. RACE FORMAT

RS8.1) For each individual category, the race day will include at least 1 official free practice session, one timed practice session and two Finals (Race 1 and Race 2), both valid for the National Series rankings.

RS8.2) During timed practice sessions, pit stops are not permitted. Any driver who stops will not be able to return to the track and their session will be over.

RS8.3) The starting grid for Race 1 will be determined by the results of the timed practice sessions, while the starting grid for Race 2 will be drawn up as described in RS3.2.

RS8.4) The finals shall be held over a distance of between 15/18 km.

RS8.5) The Organiser reserves the right to merge any categories that do not reach the minimum number of drivers required to compete in the race programme independently. In this case, separate rankings will still be drawn up.

RS9) WET RACE

RS9.1) In the event of a race being declared wet by the race director (Wet Race), national and international regulations will apply, meaning that drivers will be free to choose between Rain and Slick tyres. The race management will have the right to exclude any drivers who create dangerous situations by displaying the black flag.

RS10) COMPLAINTS and APPEALS

RS10.1) Decisions made by race officials in terms of time penalties are not subject to appeal. These measures will be reported in the rankings posted on the official race list.

RS10.2) For all measures (penalties, demotions, disqualifications, etc.) taken by the Sole Judge, the appeal provisions set out in Art.29 of the National Karting Regulations shall apply, i.e. the appeal must be notified in writing to the Sole Judge or the Race Director within one hour (60 minutes) of notification of the decision, accompanied by a fee of Euro 2,000.00.

RS10.3) Drivers-competitors have the right to submit written complaints to the Sole Judge against other drivers-competitors duly registered for the event, both for alleged sporting and technical violations. Complaints, which require the complainant to be relevant and deal with only one issue, must be signed and submitted by the Competitor to the Race Director or, in his absence, to the Sole Judge, together with a deposit of Euro 500.00 (see RSN Appendix 9 "Fees and Charges", Art. 5.2 "Security Deposits").

RS11) AWARDS

RS11.1) The following honours will be awarded at each event:

- Top 3 finishers in Race 1 and Race 2 for the overall rankings in each category

RS11.2) At the end of the championship, honours will be awarded to the top 3 finishers in the National Ranking for each individual category.

RS12) GENERAL RULES

For anything not covered by these Sporting Regulations, reference shall be made to the National Karting Regulations, the Sporting Code and the FIA Karting regulations.

RT1) R-EVO CHAMPIONSHIP TECHNICAL RULES

RT1.1) Competitive activity in every event listed on the official R-EVO CHAMPIONSHIP calendar is reserved for TBKART model S197 karts with FIA KARTING homologation number 020-CH-32 equipped with Rotax Max Evo Junior engines with approved technical specifications 065-AIE-11, which must comply with these technical regulations at all times during the event, the chassis and engine identification sheets and all supplementary regulations and technical bulletins published on the official website www.irkpromotion.com.

RT1.2) It is strictly forbidden to remove and/or add material and, more generally, any alterations (treatments, modifications, etc.) to the functions of the accessories, chassis and engine are prohibited. Anything not expressly authorised shall be deemed prohibited.

RT1.3) In the event of disputes and doubts regarding the compliance of any component of the kart during verification, the technical assessment of the chassis and engine manufacturer shall be decisive. These conclusions shall be final. Decisions regarding disputes and doubts about the compliance of any component of the kart during inspections are made by the Technical Stewards appointed by ACI Sport.

RT1.4) The only equipment - complete kart and tyres - permitted during the event will be provided on a turnkey basis by the organiser and must comply with these Regulations and its Appendices.

RT2) FRAME and Accessories

RT2.1) Only TBKART S197 chassis with FIA KARTING homologation number 020-CH-32 are permitted as standard products and equipped with original accessories.

RT2.2) No adjustments or modifications to the kart's set-up or configuration are permitted. Should a participant alter the kart's configuration, they will be disqualified from the session.

Any changes to the setup will be imposed on all participants by the promoter when certain conditions arise. Each individual participant must comply with the changes imposed by the organizer without the possibility of choosing and/or altering the adjustments or modifications indicated.

RT2.3) **Wheelbase:** the maximum overall wheelbase in dry race conditions is 1400mm.

In the event of RAIN tyres being used: a mandatory set-up imposed by the National Series technical staff will be indicated for all participants. The set-up will be communicated during the event.

RT2.4) **Brakes:** Only the standard system consisting of brake pump, calliper and disc is permitted. FIA KARTING Homologation Number 004-BRKR-90.

RT2.5) **Axle:** only the TBKART model M2 Ø50x2x1030mm code S55.017.TAG.20 axle is permitted

RT2.6) **Hubs:** only the following models are permitted: TBKART Front Hub Ø25x80mm code TBS55134 and TBKART Rear Hub Ø50mm x 90mm code TBS55160

RT2.7) **Spindles:** only the following models are permitted: Right spindle code S55M.006.80C and Left spindle code S55M.006.81C

RT2.8) **Rims:** Only DWT LV-SERIES 130MM and 212MM dry rims in magnesium and DWT DC5-SERIES 130MM and 180MM rain rims are permitted. It is not possible to modify their shape, volume or colour in any way.

RT2.9) **Steering column:** only the S55M 20 model steering column, code AJ5.007.01.1, is permitted

RT2.10) **Hexagonal Steering Bars:** only the following codes are permitted: S55.008.04G and S55M.008.05G

RT2.11) **Steering wheel:** only code S55.009.03.M7 is permitted

RT2.12) **Rear bumper supports:** The 2 rear bumper supports must always be securely fastened to the chassis.

RT2.13) **Brake pads:** only original brake pads supplied by the organiser are permitted

RT2.14) Optional parts granted:

- **Brake rod:** shorter, supplied exclusively by the organiser, code s55.013.255
- **Steering wheel hub thickness:** angled exclusively for supplier code S55.009.06G
- **Adjustable steering wheel hub:** exclusively supplied by the organiser, code S55.009.02G
- **Rear pedal board:** supplied exclusively by the organiser, code S55.012.18G

RT2.15) **Floor:** all screws and nuts must always be fitted and tightened.

RT2.16) **Front stabiliser bar and related clamps:** Front stabilizer bar and related clamps: A front stabilizer bar with related clamps is NOT used. The use of front stabilizer bars is strictly prohibited.

RT2.17) **Fairings:** only factory-fitted fairings are permitted.

RT2.18) **Rear fairing:** only standard rear bumpers are permitted.

RT2.19) **Seat:** only seats supplied by the organiser are permitted; seats with different technical specifications are not permitted.

RT2.20) During the event, and in the event of an accident, the driver may replace the chassis (frame) once only, subject to authorisation by the technical stewards. In this case, the frame and other necessary parts must be paid for in advance (prices will be specified in the organiser's price list prior to the event).

RT2.21) During the event, and in the event of an accident, the driver may replace any spare parts and/or components. In this case, they must be paid for in advance (prices will be specified in the organiser's price list prior to the event).

RT2.22) At the end of the event, drivers must return the equipment in accordance with the information regarding times, locations and return procedures defined by the organisation.

The equipment must be returned in the same working condition in which it was delivered. All equipment must be thoroughly cleaned before return, otherwise a charge of €200 will be applied.

Any damaged or missing parts of the chassis, engine, accessories or equipment provided by the organiser must be paid for.

Any damaged parts of the frame must be paid for.

Any part of the engine damaged as a result of accidents, assembly errors, off-road use, etc. must be paid for.

The persons designated by the organiser shall be responsible for carrying out a thorough check of the equipment handed over to the driver.

RT3) ENGINE and Accessories

RT3.1) Each engine is sealed with an engine seal bearing a unique serial number (barcode).

RT3.2) Engines are assigned at random (on loan for the duration of the event).

RT3.3) Mandatory settings, permitted adjustments and optional parts are defined in these Technical Regulations and its Appendices.

RT3.4) For all components outside the engine seal, the competitor is responsible for ensuring compliance with the Technical Regulations and its Appendices.

RT3.5) At any time during the event, a driver/participant who cuts or tampers with any seal or modifies any part of the engine and/or carburettor will be disqualified from the event.

RT3.6) CLUTCHES

Clutch thickness (A)

All engines minimum 24.10 mm

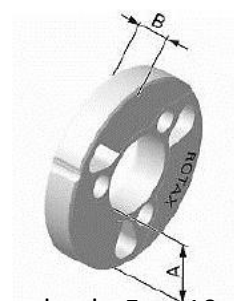

The measurement must be taken towards the 3 open points of the clutch, 5 to 10 mm from the machined groove. All clutch parts must be completely closed, with no gaps.

Clutch height (B)

Mini, Junior, Max: minimum = 11.45 mm

Outer diameter of the clutch bell (C)

Minimum = 89.50 mm

The measurement must be taken with a digital calliper towards the shoulder radius (not towards the clutch opening).

Internal diameter of the clutch bell (D)

Maximum = 84.90 mm

The measurement must be taken with a digital calliper at the centre of the bell. (In the contact area between the clutch and the bell housing)

Total height of clutch bell with pinion/primary gear (E)

Mini, Junior, Max Vminimum 33.90 mm

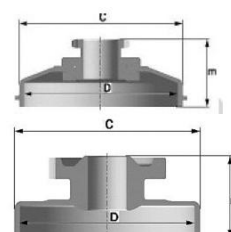

RT3.7) SPARK PLUGS

For all categories: Only NGK Gr8DI or NGK GR9DI spark plugs, as identified in the image below on the left and marked with a green circle, are permitted.

After-market parts marked with a red circle and an extended electrode are prohibited.

Electrode thickness (maximum): The 1.00 mm thickness gauge must not fit between the two electrodes.

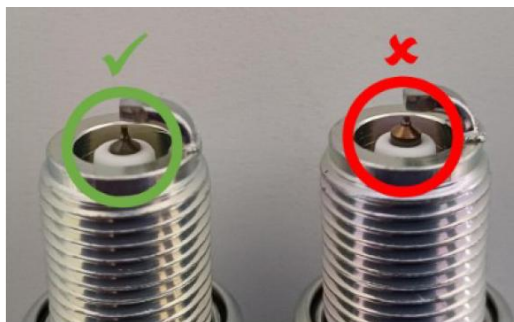

RT3.8) SPARK PLUG CONNECTOR

Only the original ROTAX spark plug connector, as shown in the image below, is permitted.



RT3.9) PETROL FILTER

Only the original TBKART petrol filter, as shown in the image below, is permitted. The filter must be fitted between the petrol tank and the pump. Only the petrol pipe, petrol pump and original filter are permitted between the tank and the carburettor. The filter is mandatory.



RT3.10) DRAIN MANIFOLD

Only Rotax 273 190 is permitted.

The measurement (C) must be at least 15.5 mm.

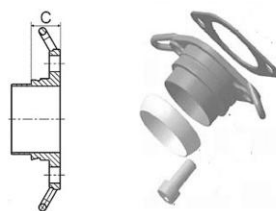

RT3.8)IGNITION

The ignition coil must be assembled with all components as shown in the illustrations below.



The visual appearance of the ignition coil must be identical to that shown in the images. The ignition coil must have 2 pins on the terminal. The ignition coil is marked with two stickers, "BRP 666820" and "NIG 0105". The ignition coil is still legal to use even if one or both stickers have disappeared. The minimum length of the high-voltage cable of the ignition coil is 210 mm (from the ignition coil output to the spark plug connector output = visible cable length).



RT3.9) CONTROL UNIT

The electronic control unit (ECU) is labelled with stickers and is still legal even if the sticker is illegible or missing.

- 125 Junior MAX: “666813”

The control unit must be checked with the control unit tester (Rotax 276230) according to the following procedure.

Disconnect the engine wiring from the control unit.

Connect the ECU tester wiring to the ECU.

Connect the power cable of the control unit tester wiring to the charging connector of the engine wiring.

Each time the tester is connected to the battery, the ECU tester software version is shown on the display for approximately 2 seconds.

The software version shown on the display must be 2V00. Start the test by pressing the "" button on the ECU tester.

After approximately 3 seconds, the second line of the display shows the type of control unit that has actually been tested.

After approximately 30 seconds, the test result will be shown in the first line of the display. The ECU tester should show the following results:

- **125 Junior MAX category**
- ☐ 666813JNRMAX
- ☐ !! Test OK !!

RT3.10) BATTERY, BATTERY SUPPORT

Only original YUASA YT7B-BS batteries (with or without Rotax sticker) are permitted.



RT4) TYRES

RT4.1) Only SHINKO tyres supplied exclusively by the organiser are permitted.

RT4.2) In the event of rain, the use of RAIN SHINKO tyres supplied exclusively by the organiser is mandatory.

RT4.3) All substances that may alter the efficiency of tyres are prohibited. Technical commissioners may carry out random checks for comparison purposes and arrange for compliance checks, including post-race checks, at the manufacturer's premises and/or affiliated laboratories. At any time during the event, the stewards may keep the tyres under *parc fermé* conditions, even for a limited number of competitors.

RT4.4) At the end of each race, all sets of tyres must be returned to the organiser, who will return them to the various participants during subsequent unofficial and official free practice sessions.

RT5) MASS

RT5.1) The total mass recorded with the driver on board in race trim, under the conditions in which the finish line is crossed, is as follows

CATEGORY	WEIGHT (KART+DRIVER)
Senior Light	155 Kg
Senior Heavy	160 Kg

The ballasts must be securely anchored to the seat with at least 2 self-locking screws and nuts. Only ballasts provided by the organiser are permitted. The maximum weight of ballast that can be mounted by each individual participant is 25 kg.

RT6) FUEL

RT6.1) Pre-mixed fuel will be supplied via the *Parc Fermé* for the entire duration of the event.

RT7) TRANSPONDER

RT7.1) The Transponder Holder must be mounted solely and exclusively on the backrest of the kart seat; other positions are not permitted.

RT7.2) The transponder for the entire race will be provided by the organiser and must be returned at the end of the race.

RT8) RACE CLOTHING

Race clothing must comply with all safety provisions established by the National Karting Regulations.

RT9) TELEMETRY

RT9.1) Only MYCHRON 5S and MYCHRON 6 systems that allow the reading/recording of the following data are permitted (not supplied by the promoter):

- a) Lap time
- b) Engine revolutions (cable supplied by the promoter, assembled on the chassis)
- c) Engine coolant temperature (water) (sensor supplied by the promoter, assembled on the chassis)

RT10) ADVERTISING

RT10.1) The promoter may, upon request, place promotional space on the livery of the karts in the race. Generally speaking, when required, these spaces are indicated by the symbol:

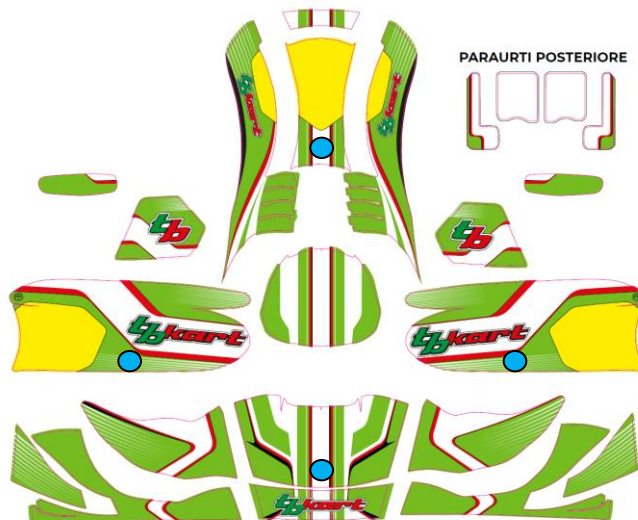

RT10.2) It is forbidden to display product and/or manufacturer logos other than TBKART on karts and race clothing.

RT11) GENERAL RULES

RT11.1) For anything not expressly mentioned in these Regulations, the general provisions of the ACI Sport National Karting Regulations, the Sporting Code and the FIA Karting regulations shall apply.

RACE CALENDAR 2026 SEASON

DATE	CIRCUIT	DESCRIPTION
05.04.2026	CREMONA CIRCUIT	ROUND 1
21.06.2026	TRACK WINNER	ROUND 2
19.07.2025	FRANCIACORTA KARTING TRACK	ROUND 3
09.08.2025	FRANCIACORTA KARTING TRACK	ROUND 4
18.10.2025	PISTA AZZURRA BORGOTICINO	ROUND 5
22.11.2025	FRANCIACORTA KARTING TRACK	ROUND 6

Revo CHAMPIONSHIP